

25 STORAGE SOLUTIONS FOR UNDER \$25

Well Styled Home

KITCHENS & BATHS

From the Editors of *Romantic Homes*, *Victorian Homes* and *Cottages & Bungalows*

\$600
DIY BATH
MAKEOVER

70+ EXPERT TIPS

- Get high-end looks for less
- Create office space in your kitchen
- Infuse your bath with luxury

KITCHENS SUMMER 2013 • WELLSTYLEDKITCHENS.COM

16
CHECKLISTS
for Goof-Proof
Remodels

EDITOR'S PICKS:
Best Kitchen
Plans for Families

DISPLAY UNTIL 5/28/13

SUMMER 2013 • \$5.99 US



From the Editors of *Romantic Homes*.

wellstyledkitchens.com



OUTSIDE THE BOX

HOW TO TRANSFORM A TINY, HISTORIC BATHROOM INTO
A MODERN MARVEL FOR YOU OR YOUR KIDS.

BY KANDICE BRIDGES • PHOTOGRAPHY BY JOHN HORNER



IS YOUR ARCHAIC BATHROOM CRAMPING YOUR BUSY MODERN LIFESTYLE? Think outside the box by moving walls as needed to incorporate borrowed space from elsewhere. Take a cue from this double bathroom remodel. The owners of this historic Victorian in Arlington, Massachusetts, loved their home's architectural details, but were unhappy with the existing configuration of their tiny master bathroom and the children's bathroom.



An open arch was built between the vanity and toilet alcove providing practical and beautiful storage. Opposite: The shower space was taken from an existing hall closet to expand the footprint of the master bath. Stunning tile work makes this a shower anyone would want to use.



The hall bath is long and narrow, but provides plenty of space for active children. The historic oval window was preserved in the shower.

CHECKLIST FOR AN HISTORIC BATH RENOVATION

- **MIRRORS:** Use sleek mirrors such as the Affina oval mirror. It is light and bright and does not weigh down the space.
- **STRETCH THE SPACE:** Is there a nearby closet that can be incorporated into your space planning? Hallway space? Bedroom space?
- **A TILE RUG:** Feinmann created the look of the tile rug with Ann Sacks Opera Mosaic in an oval pattern. The remainder of the floor in the master bathroom is Carrera marble as is the countertop.
- **LOW-FLOW TOILET:** Replace the old water-hogging toilet and with a low-flow version, such as those by Toto used in this home.
- **STORAGE:** Include smart storage that blends in with your home's period look. For instance, incorporate an historic architectural element, such as an arch, that can be used for built-in storage or open shelving. Or opt for furniture-like cabinetry; in the master bathroom, the vanity was made by Showplace Cabinetry, but Feinmann custom designed the legs to make it look more like a piece of furniture in keeping with the style of the Victorian home.



BEFORE

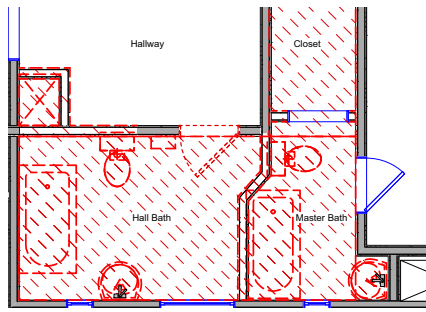

AFTER

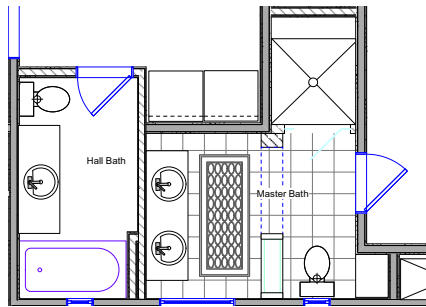

The floor plan of both existing bathrooms changed following the remodel: walls were moved to take advantage of a hall closet and space was shifted from the hall bath to the master.

REALLOCATE EXISTING SPACE

Prior to renovations, the master bathroom was actually smaller than the children’s bathroom. In this award-winning redesign, Feinmann Design/Build took space from the kids’ bath, as well as an existing hall closet, and added it to the master bath. What resulted was a sleek reallocation of the space. “This allowed the master bathroom’s ‘borrowed space’ to blossom into an airy, gracious washing alcove,” says Peter Feinmann, founder and president of Feinmann, Inc.

PRESERVE CHARMING HISTORIC ELEMENTS

When renovating, Feinmann retained particular elements in the existing bathroom that reflect the home’s historic charm and worked them into the design. In both bathrooms, two existing oval windows could not be eliminated since the home was a historically designated Victorian. The homeowners and designer incorporated these windows in the new layout. In the new children’s bath, the oval window in the shower was encased with a marble frame and glass to avoid water damage. In the master bathroom, the toilet alcove with a new eco-friendly low-flow toilet was centered around the other oval window.

SEE SOURCES, PAGE 96.

A design/build firm in Lexington, Massachusetts, Feinmann, Inc. has been creating smart, beautiful spaces for discerning clients throughout the greater Boston area for more than 25 years; to learn more, visit feinmann.com.



photo courtesy: Richard T. Anuszkiewicz | Ewing Cabinet Co | Blacksburg, VA



handcrafted metal products

*Range Hoods, Countertops,
Backsplashes & More*

The Cherry Hills Range Hood in steel with a rustic iron finish. Cooking dinner just got gratifying! Also available in zinc, bronze, stainless, copper and, yes, pewter.

Raw Urth...crave the exceptional.

866.932.7510
STEEL@RAWURTH.COM | WWW.RAWURTH.COM

